

Heard Museum Campus

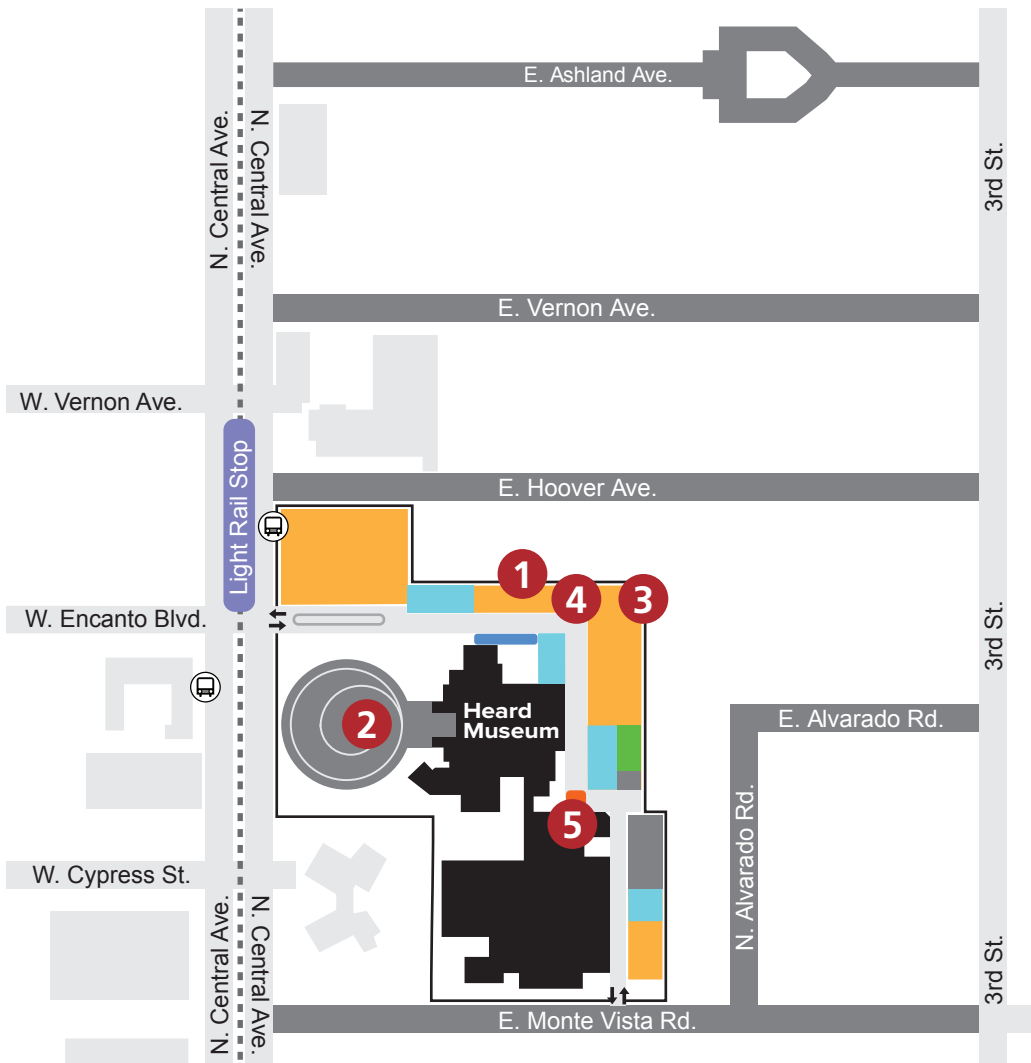

Heard Museum Visitor Parking Map

- Visitor Parking
- ADA Parking
- EV Charging Space
- Bus Drop Off and Parking
- Ride Share Drop Off
- Reserved

NO PARKING ON NEIGHBORHOOD STREETS

- | | |
|-----------------|--------------------|
| E. Ashland Ave. | E. Monte Vista Rd. |
| E. Vernon Ave. | E. Alvarado Rd. |
| E. Hoover Ave. | N. Alvarado Rd. |

- 1 Bus Bay/Student Drop-Off
- 2 Libby Amphitheater
Lunch/Snack location option
- 3 Children's Courtyard
Lunch/Snack location option
Capacity: approximately 64 adults or 80 children
- 4 Cubby storage, restrooms, and bottle filling station.
- 5 Restrooms inside the museum
(additional restrooms next to the Café)

Heard Museum Ground Floor



Key

- Non-Public
- Open for Special Events
- Outdoor Space
- ? Information
- Membership Desk
- Restrooms
- ADA Accessible Elevator
- Ramp
- Stairs

GROUND FLOOR GALLERIES

- Betty and Samuel Kitchell Gallery**
- HOME: NATIVE PEOPLE IN THE SOUTHWEST**
The Heard Museum's signature exhibition, featuring artwork from the Federally Recognized Tribal Nations of Arizona and New Mexico.
- Edward Jacobson Gallery**
Substance of Stars
- Joel and Lila Harnett Theater**
- Heardlings Family Activity Room**
Interactive gallery for kids and families
- Nichols Sculpture Garden**
- Lovena Ohl Gallery**
- Dennis H. Lyon Family Crossroads Gallery**
- Sandra Day O'Connor Gallery**
- Virginia G. Piper Charitable Trust Grand Gallery**
- Freeman Gallery**
- Monte Vista Room**

Heard Museum Second Floor

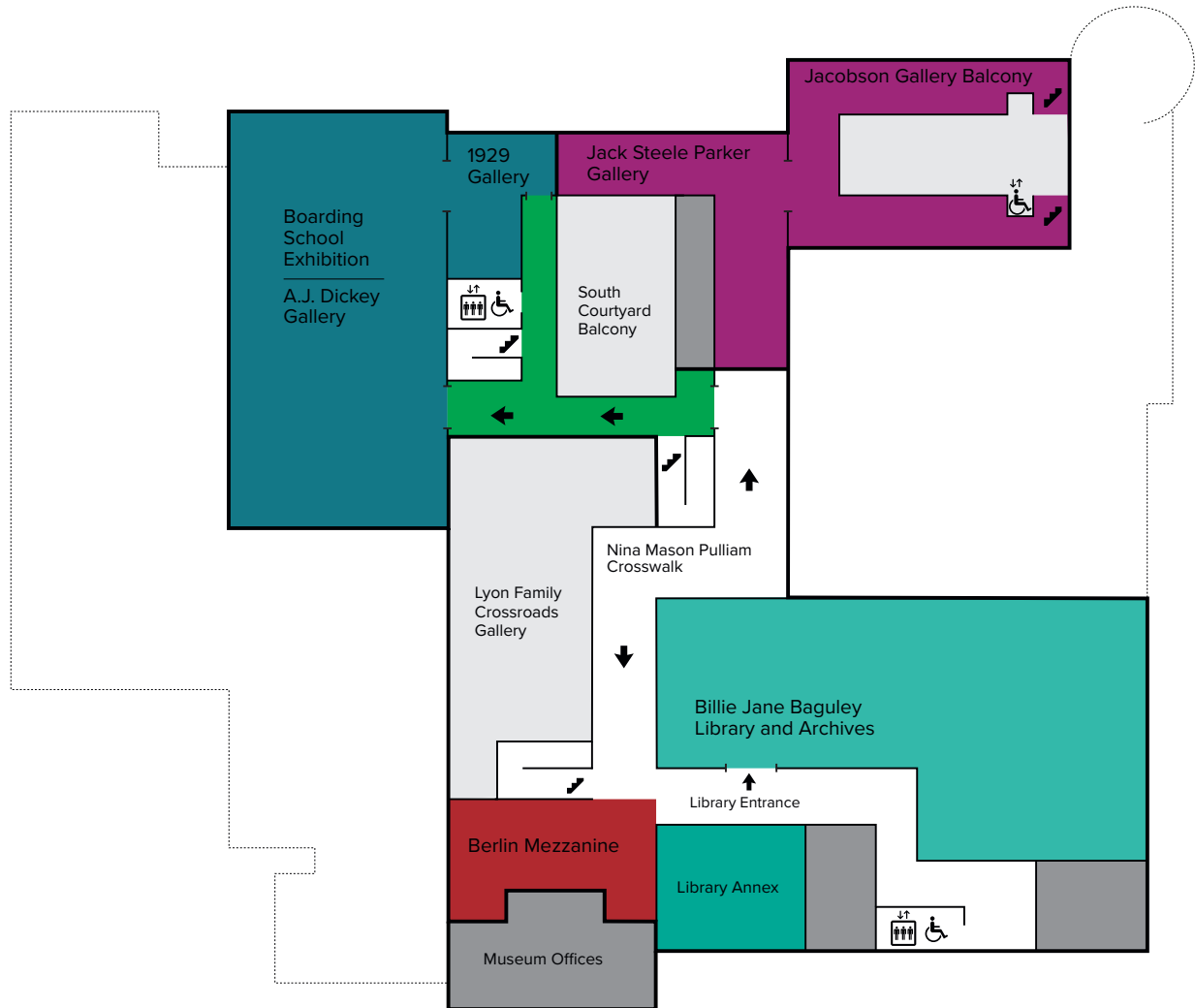

Key

- Non-Public
- ADA Accessible Elevator
- Outdoor Space
- Stairs

SECOND FLOOR GALLERIES

- Jack Steele Parker Gallery***
Substance of Stars
**accessible from ground floor only*
- A.J. Dickey Gallery**
Away from Home: American Indian Boarding School Stories.
Recommended for grades 7 and above.
- Berlin Mezzanine**
- Billie Jane Baguley Library and Archives**
Open Monday - Friday, 10 a.m. - 3:45 p.m.
Appointments required.
- 1929 Gallery**